

ACCESSORIES
SUPPLIED AND PACKED
WITH THE MOTOR
(Accessori Forniti ed Imballati
con il Motore)

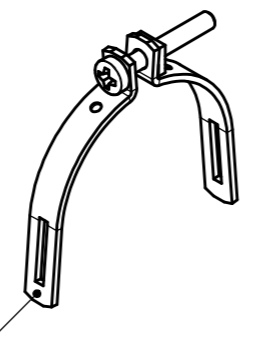

1-070-422

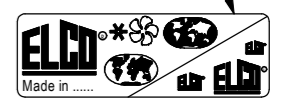
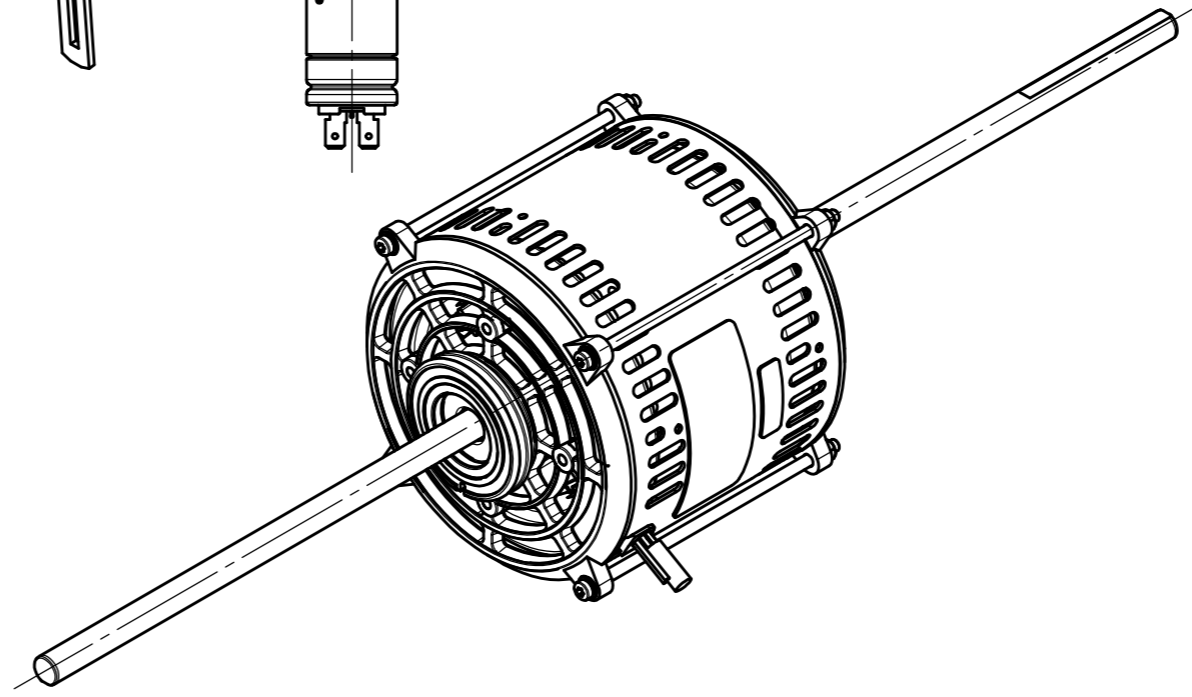
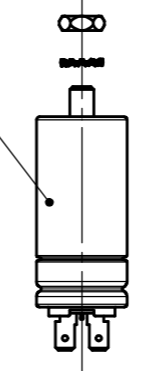

CODE: HOFB43TB0542
TYPE: 1HO 500-57-3V NA

230V ~ 50/60Hz 3,50A
500/780W TH.PROT. INS.CL.B
1300Rpm C=15µF 450VL

ROTATION ←

DATA

WHITE COMMON
BLACK MAX
BLUE MED
RED MIN
BROWN C
BROWN C
YELLOW/GREEN

CLASS "B" MOTOR - SLEEVE BEARINGS MANUFACTURED (Motore in classe "B" - Esecuzione a Bronzine)	
AXIAL CLEARANCE (Gioco assiale)	1,0 - 3,5 mm
SHELL (Fascia)	OPEN (Aperta)
END SHIELD - LEADS SIDE (Coperchio lato Cavi)	OPEN (Aperto)
END SHIELD - OPPOSITE LEADS SIDE (Cop. lato opposto cavi)	OPEN (Aperto)
ASSEMBLING SPECIFICATION No. (Normativa per note di montaggio)	EL.UN.0009
MECHANICAL SPECIFICATION No. (Normativa per note di controllo meccanico)	EL.CM.0002
ELECTRICAL SPECIFICATION No. (Controllo elettrico con prescrizione)	M.1674/ 3

Rel.	Date	Description	Executor signature	Checked

For dimension without tolerance see standard UNI EN 22768-mK

Treatment
Material

ELCO

Drawn Pedrini R.
Date 20-06-2018
Check F. Crigola
Scale ---

SINGLE PHASE MOTOR
MOTOR 1 HO 500-57-3V NA
230V 50/60Hz Th.Prot. CL.B

Weight gr.
Ref. No 4-010-1402/1

A3

Release -

HOFB43TB0542